

Harvard Elementary

Arrival and Dismissal Plan

2020-2021

Building Entry – Arrival/Dismissal

- All employees, students, and visitors must check in at designated Wellness (screening) stations.
 - Visitors will have their temperature checked and asked if they are experiencing any symptoms
 - Visitation will be limited to those with scheduled appointments or for essential visits
- No-contact morning arrival/afternoon dismissal location times
 - Signage will be visible
 - Locations will be announced prior to first day
 - Car riders will need to get in and out of the car independently
 - Parents may not walk students into the building
 - Students who do not have a mask will be provided one upon entry
- The use of masks covering the nose and mouth are required at all times for all students, teachers and staff.



Arrival

To ensure the safety and contact tracking of students:

Same entrance daily:

PreK & K: Kinder Entrance

1 & 2: South Wing Entrance

3rd, 4th and 5th: Main Entrance

*Siblings enter/exit with the youngest child.

*Encouraging all students to utilize car-rider line only.

*Arrival will begin at 7:20 AM.



Arrival Map

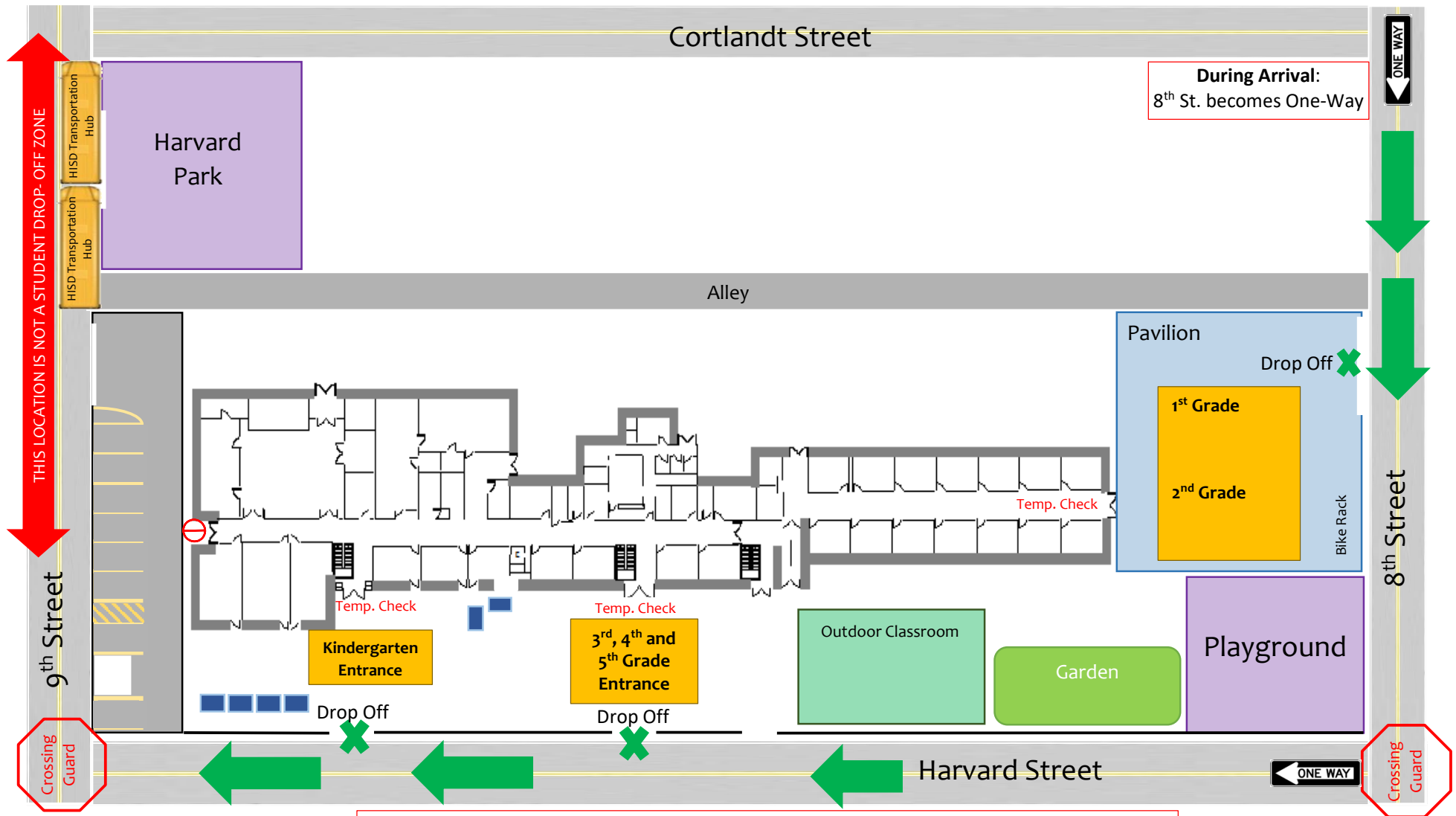

FOR THE SAFETY OF OUR STUDENTS:

- PLEASE REMAIN IN LINE AND DO NOT PASS CARS OR BUSES.
- PLEASE USE THE CROSSING GUARD TO SAFELY CROSS THE STREET.

Dismissal

Dismissal will be staggered.

- Walker or car rider must be indicated on our dismissal survey form and cannot be changed to assist in dismissal procedures.
- Walkers will begin dismissal at 3:00.
- Parents in any walker pick-up line must adhere to social distancing and wear a mask.
- Car Riders will begin dismissal shortly after walkers are dismissed.
- All Pre K & K students will act as walkers for dismissal only.
- 5th grade students can still walk independently with a waiver on file with the front office.
- We will be distributing numbers to families for dismissal.

*Siblings enter/exit with the youngest child.

Dismissal Map



LINE STARTS HERE

Cortlandt Street

During Dismissal:
8th St. becomes One-Way

EXIT

3rd, 4th and 5th Grade Walkers

Harvard Park

Alley

9th Street

Pavilion

1st Grade

2nd Grade

Bike Rack

8th Street

Kinder Walker

Pre-K

Kindergarten Walkers

Bus Ride
3rd, 4th and
5th Grade
Car Riders

Outdoor Classroom

Garden

Playground

LINE
STARTS
HERE

Crossing Guard

crossing

MAGNET SCHOOL BUSES ONLY

Harvard Street

Car Rider Pick- Up



FOR THE SAFETY OF OUR STUDENTS:

- PLEASE REMAIN IN LINE AND DO NOT PASS CARS OR BUSES.
- PLEASE USE THE CROSSING GUARD TO SAFELY CROSS THE STREET.

During Dismissal:

Harvard St.
becomes One-Way

Dismissal: Pre K and Kindergarten

All Pre K & K students will act as walkers only.

Walkers will begin dismissal at 2:50 PM.

- Parents must line up on the Harvard St. sidewalk, facing north, toward FCH.
- Those in the walker line must adhere to social distancing and wear a mask.
- The line begins at the Kinder Gate.

*Siblings enter/exit with the youngest child.

Dismissal: 1st & 2nd

Walkers will begin dismissal at 2:50 PM.

Car Riders will begin dismissal shortly after walkers are dismissed.

Walkers:

- Parents must line up on the 8th St. sidewalk, facing east, toward Cortlandt St.
- Those in the walker line must adhere to social distancing and wear a mask.
- The line begins at the South Wing Gate.

Car Riders

- Parents must line up on the 8th St., facing west, toward Harvard St.

*Siblings enter/exit with the youngest child.

Dismissal: 3rd & 4th

Walkers will begin dismissal at 2:50 PM.

Car Riders will begin dismissal shortly after walkers are dismissed.

Walkers: @ Harvard Park

- Parents must line up on the 9th St. sidewalk, facing east, toward Cortlandt St.
- Those in the walker line must adhere to social distancing and wear a mask.
- The line begins at the Harvard Park Side Gate. (located on 9th.)

Car Riders: @ Car Line in Front of Building

- Parents must line up on Harvard St., facing north, toward FCH.
- Students will exit through main entrance as their car is visible in the line.

*Siblings enter/exit with the youngest child.

Dismissal: 5th

Walkers will begin dismissal at 2:50 PM the first week of school.
Car Riders will begin dismissal shortly after walkers are dismissed.

Walkers: @ Harvard Park

- Parents must line up on the 9th St. sidewalk, facing east, toward Cortlandt St.
- Those in the walker line must adhere to social distancing and wear a mask.
- The line begins at the Harvard Park Side Gate. (located on 9th.)
- 5th grade students can walk home independently as long as a walker waiver is on file with the front office. (google form) Siblings are not to walk home with the fifth grader.

Car Riders: @ Car Line in Front of Building

- Parents must line up on Harvard St., facing north, toward FCH.
- Students will exit through the outdoor classroom door as their car is visible in the car-rider line.

*Siblings enter/exit with the youngest child.

Transportation

- Daycare transportation available through the Daycare Provider and must be secured by the parent.
- District transportation will be provided to special education, homeless, and priority students.
 - District transportation: Social distancing will be enforced. Masks will be required.

